

## IBUS-1U/SP



### Pentium III M/board 850MHz CPU, 40GB IDE HDD, 2 Full Length PCI Slots

Maximize return on investment (ROI) with application ready platform (ARP) configurations from IBUS. IBUS is proud to introduce the -1U/SP, a cost effective, revision controlled ARP, tested with Windows NT 4, Windows 2000 and Red Hat Linux. Choose from an available range of pre-qualified configuration options. IBUS-1U/SP allows OEMs, VARs and Systems Integrators to provide 1U space conscious platforms for enterprise class customer premise application support.

Ideal for front-end applications like web servers, media streaming or utilities hosting

#### 1U/SP features and benefits:

- Delivered as application ready platforms with all hardware and software integrated
- Compact, 17"x17" enclosure can be deployed as 19" rack mount or desktop
- Revision controlled 815e chipset motherboard for cost-effective Pentium III support
- Integrated dual 10/100baseT Ethernet, video and CompactFlash free up expansion slots
- Choose to have Windows 2000, Windows NT 4 or Red Hat Linux installed and tested
- IDE or SCSI disk, Networking, and Modem options available
- Revision control and guaranteed upgrade path from IBUS on all components = maximum ROI

Integrated to order in ISO9001 accredited facilities worldwide.  
Rack cabinet, UPS and Product/Packaging branding options available.

The range of application ready platforms from IBUS are flexible building block systems designed to meet the present and future needs of the converging technologies marketplace. ARPs is a range of scalable, reliable, open standards-based solutions, designed to leverage OEM, VAR and Systems Integrators' own added value, with unparalleled speed and efficiency, maximizing return on investment while minimizing time to market.

IBUS-1U/SP is an ideal platform for Windows or Linux based applications which require one or more PCI expansion boards in a cost-effective package. The revision controlled, Intel® 815e chipset motherboard and risers provide single 66/100/133MHz FSB socket 370 CPU support with two full-length, full-height, 32bit/33MHz PCI expansion slots available as well as a single CompactFlash socket.

The IBUS-1U/SP is the ideal platform for an embedded Windows or Linux platform, deployed in a desktop or 19" rack cabinet role in an enterprise class or customer premise environment. The compact size and plain, inconspicuous design, plus the cost effective, revision controlled configuration, make this an ideal cost-sensitive platform for applications where the 1U system becomes the Field Replaceable Unit (FRU).

## Specifications

### Chassis

#### 1U Height

- 1.75" x 16.79" x 15.75", 44 x 426.5 x 400 mm (HWD)

### Internal Hardware

- Intel® 815E chipset
- 2 RJ45 10/100 baseT Ethernet ports
- Video controller on-board with 1 DB-15 video port
- 2 slot, 32 bit/33MHz PCI riser board
- Two 168-pin DIMM sockets for 512 MB RAM
- 66/100/133 MHz front side bus
- Configurable Watchdog Timer
- Monitor and alarm for processor temperature and fans
- Revision control for extended availability
- 1 internal connector for CompactFlash memory card
- 1 IEEE 1284 compatible DB-25 parallel port
- 2 DB-9 serial ports
- 2 USB ports
- 1 mini-DIN-6 PS2 mouse port
- 1 mini-DIN-6 PS2 keyboard port

### Thermal Management

- 100,000 hr MTBF CPU heatsink and fan
- High efficiency blower (75 mm, 4200 rpm, 13.1 CFM @20.8 mm)
- 3 Fans (40 mm, 6400 rpm, 6.8 CFM @0.11 mm)
- Power supply exhaust fan
- Monitor and alarm for processor temperature and fans

### CompactFlash Expansion

- Single expansion slot for standard CompactFlash modules in motherboard (see ordering info)

### Power Supply

- 150 watt
- Output (ATX format connectors)
  - + 5V @14A (max) -5V @0.3A (max)
  - + 3.3V @10A (max) -12V @0.8A (max)
  - + 12V @4.5A (max) +5Vsb 1A/2A
- Input: 115/240v VAC, auto-selecting, 47 to 63 Hz
- Power Factor Correction

### Construction/Finish

- Type of metal: Pre-coated phosphate 1mm steel
- Finish: Textured paint, black

### Operating Environment

- Enterprise environments, such as computer rooms, data centres, racks in office, studio, control centre or cable head-end environments, with low incidence of airborne particles and no moisture such as precipitation or other water sources.
- Operating Temperature: 0°C - 45°C ambient
- Humidity 20% - 80% non-condensing

### Standards Compliance

- CE, FCC and UL/CUL

### Warranty

- Two year return to factory warranty on system and parts

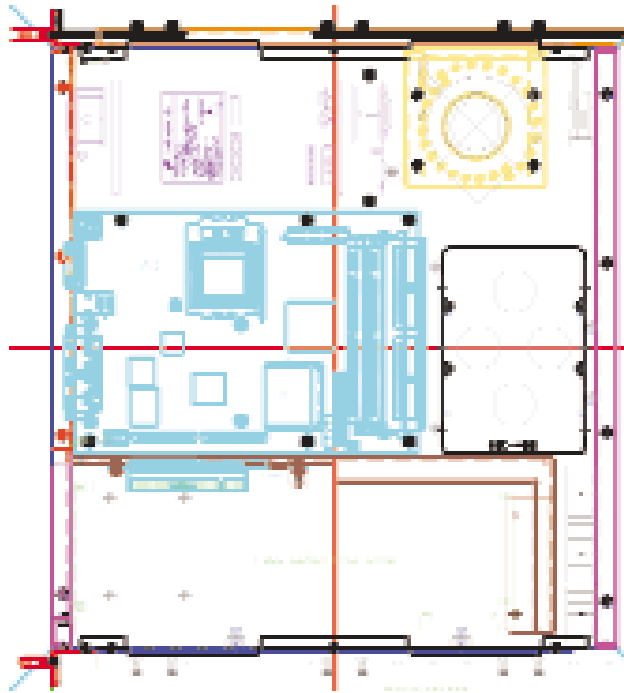

## Ordering Information

### IBUS-1U/SP

#### Standard Configuration

- 1U desktop or rack mount enclosure, Intel® 815e chipset system with Pentium III 850MHz CPU, 256Mb SDRAM, 40Gb, 7200rpm IDE disk integrated. Comes with manual and driver software.

#### Options

(Alternatives to standard configuration above unless otherwise stated)

#### CPU Options

- Intel® Pentium-III 1GHz CPU

#### SDRAM Options

- Total 128Mb PC-133 Low-Profile Kingston SDRAM (1x 128Mb DIMM)
- Total 512Mb PC-133 Low-Profile Kingston SDRAM (2x 256Mb DIMM)

#### Compact Flash

- 64Mb Compact Flash installed and tested

#### Operating System Options (Installed)

- Windows 2000 Professional OEM
- Windows 2000 Server OEM (5 client license)

- Windows NT 4 Workstation OEM
- Windows NT 4 Server OEM (5 client license)
- Red Hat Linux 7.2

#### Network Connectivity Options

- Intel® single port 10/100baseT network card
- Intel® dual port 10/100baseT Server Ethernet adapter
- Intel® single port 1000baseT Server Gigabit adapter

#### SCSI & Device Options

- Adaptec 29160 single channel SCSI adapter
- Adaptec 39160 dual channel SCSI adapter
- 18Gb (fixed) Ultra-160 SCSI disk instead of 40Gb IDE
- 36Gb (fixed) Ultra-160 SCSI disk instead of 40Gb IDE

#### SNMP System Monitoring

- AMI MegaRac SNMP monitoring card, installed and tested

#### PCI Modem

- US Robotics 56K V90 Windows internal modem

#### Worldwide Headquarter

IBUS Corporation  
7627 Morro Road  
Atascadero, CA. 93422  
United States  
Tel : (805) 460-0531  
Toll Free : 800 382 4229  
Fax : (805) 461-4001  
Email : sales@ibus.com

#### European Headquarter

IBUS UK  
Unit 6, Chichester Business Park  
City Fields Way, Tangmere  
West Sussex, PO20 2LB, UK  
Tel : +44 (0) 1243 756300  
Local rate : 0845 450 4500  
Fax : +44 (0) 1243 756301  
Email : sales@ibus.co.uk

#### France & Italy

IBUS France  
Les espaces de Sophia  
80 route des Lucioles  
06901 Sophia-Antipolis CEDEX  
France  
Tel : +33 (0)493 00 4360  
Fax : +33 (0)493 00 4369  
Email : info@ibus.fr

#### Scandinavia

IBUS Sweden  
Drakegatan 10  
BOX 184  
401 23 Göteborg  
Sweden  
Tel: +46 (0)31-773 7117  
Fax: +46 (0)31-773 7075  
Email: pry@ibus.com